

MS-332-7



MS-332-7

Normally Closed Reed Sensor

Electrical Characteristics @ 25 °

Contact form		B
Contact rating max.	W / VA	5
Switching voltage max.	VDC	175
	VAC	120
Switching current max.	A	0.25
Carry current max.	A	1.5
Breakdown voltage min.	VDC	200
Total resistance max. (initial)	mΩ	200
Insulation resistance min.	Ω	10 ⁹

Features

- No power supply required
- Customized types available
- Various sensitivity ranges available
- Non pole oriented actuation

Magnetical Characteristics (of unmodified Reed Switch) @ 25 °

Pull in range available	AT	15 - 30
Drop out min.	AT	5
Test coil	TC -	200
Test equipment tolerance	± AT	2

Operating Characteristics (of unmodified Reed Switch) @ 25 °

Switching frequency max.	Hz	100
Resonant frequency typ.	Hz	1100
Operate time max. (incl. bounce)	ms	0.7
Release time max.	ms	1

Approvals



Contact PIC for Agency Ratings!

Environmental Characteristics

Operating temperature	°C	-20 to + 85
Vibration (50-2000 Hz)	g	30
Shock (1/2 sin 11 ms)	g	50

Ordering Information

Packing Unit	50 pcs
Weight per piece	5.8 g
Weight per package	300 g
Standard AT Ranges	

- 2 = 15 to 20 AT
- 3 = 20 to 25 AT
- 4 = 25 to 30 AT

Ordering Example

MS-332-7-2 describes MS-332-7 with 15 to 20 AT.

Remarks

When mounted onto ferromagnetic parts switching distance of MS-332-7 may reduce. Electromagnetical influences and magnetic fields may change the switching behaviour of the sensor.

Dimensions in mm

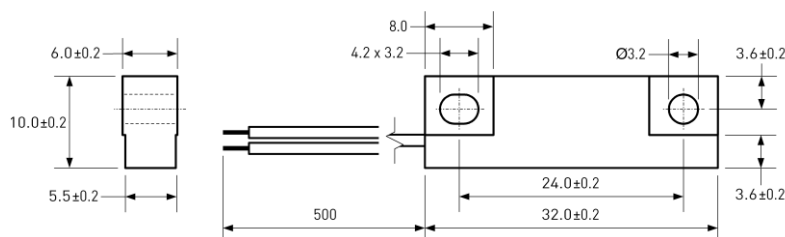

Material Information

	Material	Colour
Housing	ABS	black
Cable	UL 1007/1569, AWG 24, 4 mm stripped and tinned	black
Potting compound	Epoxy	black