

**MS-332-3**



**MS-332-3**

Standard Reed Sensor Flatpack

**Electrical Characteristics @ 25 °**

Contact form		A
Contact rating max.	W / VA	10
Switching voltage max.	VDC	200
	VAC	140
Switching current max.	A	1
Carry current max.	A	1.2
Breakdown voltage min.	VDC	240
Total resistance max. (initial)	mΩ	200
Insulation resistance min.	Ω	10 <sup>10</sup>

**Features**

- No power supply required
- Replaces various competitors types
- Various sensitivity ranges available
- typ. Load resistive

**Magnetical Characteristics (of unmodified Reed Switch) @ 25 °**

Pull in range available	AT	10 - 25
Drop out min.	AT	4
Test coil	TC -	014
Test equipment tolerance	± AT	2

**Operating Characteristics (of unmodified Reed Switch) @ 25 °**

Switching frequency max.	Hz	500
Resonant frequency typ.	Hz	4000
Operate time max. (incl. bounce)	ms	1
Release time max.	ms	0.4

**Approvals**



Contact PIC for Agency Ratings!

**Environmental Characteristics**

Operating temperature	°C	-20 to + 85
Vibration (50-2000 Hz)	g	20
Shock (1/2 sin 11 ms)	g	100

**Ordering Information**

Packing Unit	50 pcs
Weight per piece	5.8 g
Weight per package	300 g
Standard AT Ranges	

- 1 = 10 to 15 AT
- 2 = 15 to 20 AT
- 3 = 20 to 25 AT

**Ordering Example**

MS-332-3-2 describes MS-332-3 with 15 to 20 AT.

**Remarks**

When mounted onto ferromagnetic parts switching distance of MS-332-3 may reduce. Electromagnetical influences and magnetic fields may change the switching behaviour of the sensor.

**Dimensions in mm**

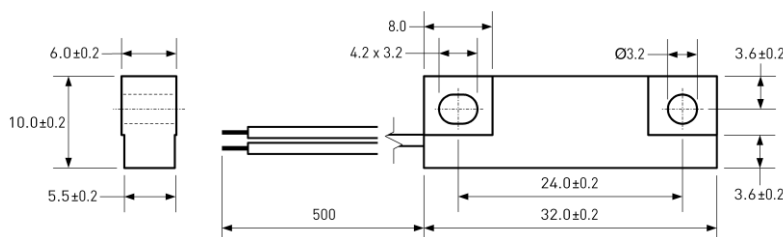

**Material Information**

	Material	Colour
Housing	ABS	black
Cable	UL 1007/1569, AWG 24, 4 mm stripped and tinned	black
Potting compound	Epoxy	black