

MSM-2431

Press-fit Magnet



Data

Housing Material	PA66, weiß
Potting Material	Epoxy, black
Orientation	over housing length

Magnetic Material	N35H	
Remanence Br	mT	1190
Coercivity HcB	kA/m	870
Coercivity HcJ	kA/m	1350
Energy Product (BH) max.	kJ/m ³	275
Magnetic Moment M	x10 ⁻⁵ Vs cm	10
Operating Temperature	°C	-20 to +85
Temperature Coefficient Tk(Br)	%/°C	-0.11

Nominal values unless otherwise specified

Dimensions in mm

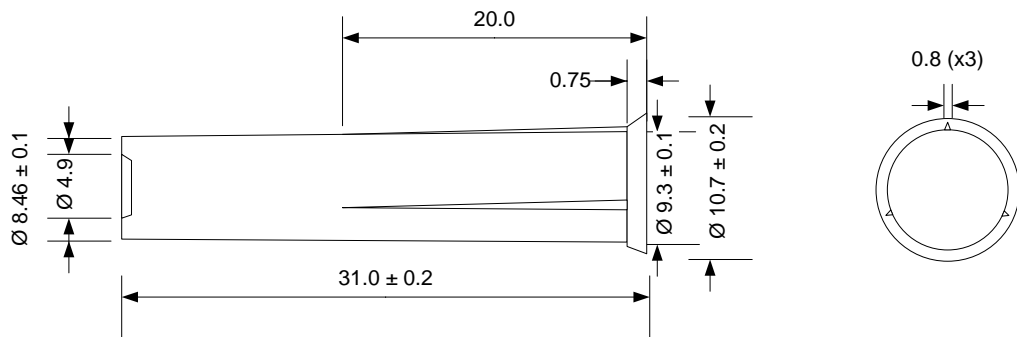

Customized types, other magnet materials and high temperature grades available.